



600TVL, TRUE Day/Night, Weatherproof, IR Bullet Cameras

KEY FEATURES AND BENEFITS

- Superior High 600TVL Resolution (Color); 700TVL (B/W)
- High Performance 1/3" Sony Super-HAD Color CCD Technology
- True Day / Night and Sense-Up (2-256x) Functionality for extreme low light conditions
- Varifocal Auto-Iris Lens in 3 configurations
- External adjustments for focal length and focus
- 24 Position Privacy Zone, Eclipse, Sharpness and Mirror Features
- Smart LED Technology: Automatically Adjusts Intensity of LED
- 3D Digital Noise Reduction (DNR) Settings for increased picture quality and lower file sizes for digital recording
- Dynamic Range Control (DRC) for brighter video image in low lighting conditions
- Test monitor video cable with local OSD control
- Weatherproof IP66 Rating for Outdoor Environments
- OSD (On Screen Display) Programming for Control of all Camera Functions
- Dual Voltage Operation (12VDC / 24VAC)
- Through Mount Wiring (TMW) for easy and secure installation

ORDERING INFORMATION

SCN#	Item
A-CBVT2812UI	Bullet Camera, 600TVL, 2.8-12mm VF AI, IP66, TDN, 42 IR LEDs, 12VDC/24VAC, White
A-CBVT9022UI	Bullet Camera, 600TVL, 9-22mm VF AI, IP66, TDN, 42 IR LEDs, 12VDC/24VAC, White
A-CBVT6050UI	Bullet Camera, 600TVL, 6-50mm VF AI, IP66, TDN, 72 IR LEDs, 12VDC/24VAC, White



**Business
Solutions**

MNI2064-00

600TVL, TRUE Day/Night, Weatherproof, IR Bullet Cameras

Product Specifications

Video

Image Sensor	1/3" Sony Super-HAD CCD
Total Number of Pixels	795(H) x 596(V)
Scanning System	2:1 Interlace
Scanning Frequency	15.734KHz(H) x 60Hz(V)
Sync. System	Internal / Line Lock
Electronic Shutter	1/60 ~ 1/120,000 sec
Resolution	600TVL
Min. Illumination	0.1 lux (Color) @ F1.2, 50 IRE, 0 Lux (IR LED ON)
Video Output	1.0Vp-p @ 75ohm, composite)
S/N Ratio	>55dB (AGC OFF, Sense up OFF)
IR LED	42 LED's (2.8-12mm and 9-22mm models); 72 LED's (6-50mm model)
IR LED Lighting Distance	120ft (40M) (2.8-12mm and 9-22mm models); 180ft (60M) (6-50mm model)

Function

Exposure Shutter	1/60, FLICKERLESS, 1/250~1/120,000sec
Lens (Auto Iris Control)	DC / ELC
Brightness	0 ~ 60
BLC	OFF/ON
AGC	OFF / LOW / MIDDLE / HIGH
Sense-up	OFF / 2-256x
Eclipse	OFF / ON
3D-DNR	OFF / LOW / MIDDLE / HIGH
DRC (Dynamic Range Control)	OFF / ON
White Balance	ATW / AWC / MANUAL / INDOOR / OUTDOOR
Day & Night	AUTO / DAY / NIGHT / EXT
Privacy Zone	OFF / ON (24 Position, Masks BW, Color, Mosaic)
Display Title	OFF / ON
Video Picture	POSITIVE / NEGATIVE
Sharpness	0~15
Mirror	NORMAL / MIRROR / VERTICAL / ROTATE
Sync	INT / AUTO
Phase (Line Lock)	0~524

General

Power Input	2-Pin Terminal Block
Power Source	12VDC / 24VAC (-10%, +15%)
Power Consumption	5W (2.8-12mm and 9-22mm models); 8W (6-50mm model)
Video Output	BNC
Lens	2.8-12mm, 9-22mm, or 6-50mm F1.2~360 Varifocal DC Auto-Iris ICR
Operating Temperature	14°F~122°F (-10°C~+50°C)
Operating Humidity	0~96% (non-condensing)
IP Rating	IP66
Dimensions (Dia x Length)	3.1 x 9.9in (78 x 251.6mm)
Conformity Certifications	FCC, UL, CE, RoHS

Specifications are subject to change without notice.

Optional Accessories

A-CM150	Corner mount
A-CM151	Pole mount

Dimensions

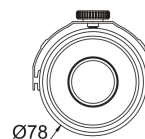
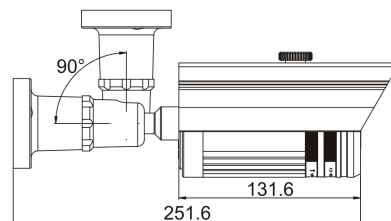

Lens Control

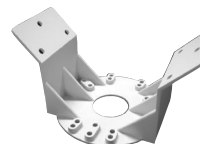
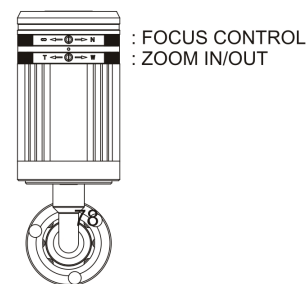

A-CM150
Corner Mount

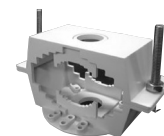

A-CM151
Pole Mount

For more information visit www.ADT-Matrix.com

© 2011 ADT—All Rights Reserved. ADT Security Services Inc. ADT, the ADT logo and ADT Always There are registered trademarks of ADT Services AG and are used under license.



**Business
Solutions**