



## Compact 22X PTZ Dome, TRUE Day/Night, WDR Camera

### KEY FEATURES AND BENEFITS

- 22x motorized zoom lens (3.9-85.8mm); 16x digital
- 580TVL high resolution camera
- TRUE day/night functionality for low-light conditions
- 4 Tours such as Preset, Pattern, and Auto-Scan can be programmed with over 150 functions and Preset locations
- 4 Auto Scans with normal, vector, random and endless Auto-Pan with 13 speed steps
- 120 preset positions; 4 Patterns and 4 Privacy zones
- WDR functionality for high-contrast lighting conditions
- Built-in 16x digital zoom with True Night Shot function
- 1 Alarm input / 1 output
- Variable panning speed from 0.1°/sec to 380°/sec.; 360° continuous rotation
- Multi-language Menu Display, Password Confirmation
- Built-in RS-485 receiver driver
- IP66 Weather-Resistant Rating
- Includes TX1B 1-channel dome interface unit and 60ft (18.2m) RJ-11 cable
- 300 ft (90m) maximum cable length
- Controlled from DVR unit or optional keyboard controller
- Wall, ceiling and flush mount options

### ORDERING INFORMATION

**SCN#**            **Item**  
 A-CC22PTZK    PTZ Dome, 22x zoom, TDN, WDR, 1-ch dome interface, 60' cable



**Video Solutions**

# Compact 22X PTZ Dome, TRUE Day/Night, WDR Camera

## Product Specifications

### Module

CCD Type	1/4" EXview HAD CCD
Optical / Digital Zoom	22X / 16X
Resolution	580TVL
Focal length	3.9mm~85.8mm
Angle of view	3.9mm~49.5°(H) 85.8mm~2.4°(H)
F-Number	F1.6~F3.7

### Min. Illumination

Normal	0.5 Lux
Slow Shutter	0.01 Lux
ICR on & Slow Shutter	0.001 Lux
ICR on (Day & Night)	YES
WDR	YES
Motion Detection (in PRESET)	YES

### Dome

Tilt angle	0° ~ 180° (Digital Flip)
Image Flip	YES
Auto Calibration	0.1° ~ 6°
Panning angle	360 continuous rotation
Alarm	1 input (NC/NO), 1 TTL outputs
Auto Scan	1 auto pan & 4 auto scan capability
Preset	120 presets with individual camera AE setup
Pattern	4 patterns (recording up to 200 sec.)
Tour	4 tours (consist of 42 functions/1 tour)
Max Speed	380° sec
Area Title	Divided into 8 areas with 12 characters of title
Privacy Zone	4 privacy zone masking (2 methods selectable : Block / video off)

### Electrical

Power Source	24VDC +10/-5%
Power Consumption	12W
Control	RS-485, baud rate: 2400~19.2k bps (default: 9600bps)
ID (Camera Address)	1~255

### Environmental

Operating temperature	-10°C ~ 50°C (14°F ~ 122°F)
Operating humidity	0 to 90%RH (non-condensing)
Storage temperature	-20°C ~ 60°C (-4°F ~ 140°F)

### Mechanical

Dimension	6.06 x 5.51in (154 x 140mm)
Weight	3.3lbs (1.5kg)

### Certifications

CE EMC, UL, CSA, FCC RoHS

### TX1B 1-Ch Dome Interface

Input	One 6-pin modular jack, RJ-11
Output	One BNC for video connection 3-pin terminal block for data
Power Input	DC jack 2.1mm
Power Supply	24VDC 2.0A
Dimensions (WxD)	3.39" x 1.57" x 2.17" (86mm x 40mm x 55mm)
Net Weight	0.43 lbs (195g) (approx.) 0.9 lbs (405g) (approx.)
Ambient Temperature	0°C ~ 35°C (32°F ~ 95°F)
Ambient Humidity	10% ~ 90% (non-condensing)

Specifications subject to change without notice.

### Optional Accessories

A-PKBD	Keyboard Controller
A-PEXM	Ceiling Mount Bracket
A-PPDM	Ceiling Pipe Mount Adapter
A-PFM	Flush Mount Ceiling Bracket
VDMWC2	Wall and Ceiling Mount

### Dimensions

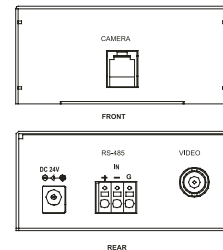
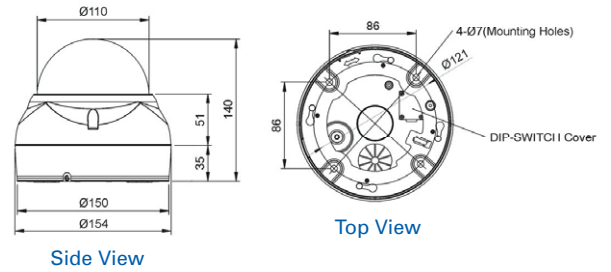

"TX1B  
1-Ch Dome Interface



A-PEXM  
Ceiling Mount Bracket



A-PKBD  
Keyboard Controller



A-PPDM  
Ceiling Pipe Mount Adapter



A-PFM  
Flush Mount Ceiling Bracket



VDMWC2  
Wall and Ceiling Mount

For more information visit [www.ADT-Matrix.com](http://www.ADT-Matrix.com)

© 2011 ADT—All Rights Reserved. ADT Security Services Inc. ADT, the ADT logo and ADT Always There are registered trademarks of ADT Services AG and are used under license.



ADT Always There®