



TRUE Day/Night, Digital-WDR, 600TVL Full Body Camera

KEY FEATURES AND BENEFITS

- | | |
|--|--|
| <ul style="list-style-type: none"> • High performance 1/3" Sony Super HAD CCD Technology • Excellent video quality with 600TVL resolution (700TVL, B/W) • 2.8-12mm A/I Varifocal lens • TRUE Day/Night (TDN) operation with programmable settings • On Screen Display (OSD) with Tactile programming switch • Digital Wide Dynamic Range (D-WDR) and Dead Pixel Cancellation (DPC) | <ul style="list-style-type: none"> • 2D Digital Noise Reduction (2D-DNR) • Back Light compensation (BLC) and High Light Compensation (HLC) • Privacy Masking (8 position) and Video Motion Detection (4 areas) • Negative and mirror image, sharpness and lens shading functions • Includes wall/ceiling mount • 12VDC/24VAC |
|--|--|

ORDERING INFORMATION

SCN#	Item
A-CC600T	Full body camera, 600TVL, TDN, D-WDR, 2.8-12mm AI, 12/24V



Business Solutions

TRUE Day/Night, Digital-WDR, 600TVL Full Body Camera

Product Specifications

Video

CCD Image Sensor	1/3" SONY Super HAD CCD
Total Pixels	811 (H) x 507(V)
Scanning System	2:1 Interlace
Scanning Frequency	15.734KHz (H), 59.94Hz (V)
Sync. System	Internal / Line Lock / Anti-Rolling
Electronic Shutter	1/60 ~ 1/100,000
Resolution	600TVL color; 700TVL B/W
Minimum Illumination	0.1 lux (color), 0.04 lux (B/W)
Video Output	1.0Vp-p (75-ohm, composite)
S/N Ratio	> 50dB (AGC off, Sense UP off)
OSD Camera Control	Tactile Switch

Functions

2D-DNR	Off/On
Dead Pixel Cancellation (DPC)	Auto (64 Points)
Lens	Manual / DC
Back Light Compensation (BLC)	Off/BLC/HLC (High Light Compensation)
Auto Gain Control (AGC)	Off/Low/Middle/High
Burst	Off/On
White Balance (WB)	AWC/ATW/Manual/Push
Day / Night	Auto/Color/B&W/Ext
Video Motion Detection (VMD)	Off / On (4 Areas)
Privacy Masking	Off / On (8 Position)
Display Title	Off / On
Sharpness	0-31
Lens Shading	Off/On (0-255)
Font Color	16 color, ID & Title
Display	CRT/LCD/User
Negative Image	Off/On
Mirror	Off/On
Digital-WDR	Off/On (0-20)

Connectors / Mechanical

Power Input	2-pin Terminal Block / DC Jack
Composite Video Output	BNC
Lens Mount	CS
Lens	2.8-12mm, F1.2 Varifocal, DC Auto Iris

Environmental

Operating Temperature	14°F ~ 122°F (-10°C ~ 50°C)
Operating Humidity	0~96% (non-condensing)

General

Dimensions (W x H x D)	2.6 x 2.2 x 4.7in (66 x 63 x 120mm)
Weight	0.88lbs (0.4kg)

Power

Voltage	12VDC/24VAC
Power	2.5W

Approvals

UL, FCC, CE, RoHS

Specifications are subject to change without notice.

Optional Accessories

A-CM150	Corner mount for A-EHWMHB
A-CM151	Pole mount for A-EHWMHB
EHWMHB	Environmental Camera Housing
SCV55014DC	5 - 50mm VF, DC AI Lens

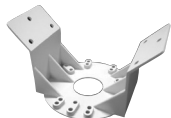

A-CM150



A-CM151



EHWMHB



SCV55014DC

Dimensions

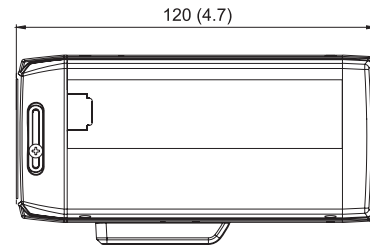

SIDE VIEW

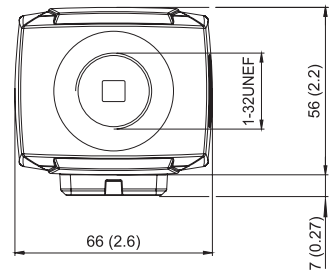

FRONT VIEW

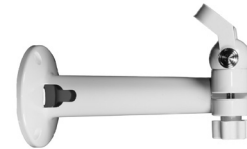

Wall/Ceiling Mount Included

For more information visit www.ADT-Matrix.com

© 2012 ADT—All Rights Reserved. ADT Security Services Inc. ADT, the ADT logo and ADT Always There are registered trademarks of ADT Services AG and are used under license.

