



A-CB7T2812PI



A-CB7D36PI



A-CB7D60PI



Compact, 700TVL Bullet Cameras

KEY FEATURES AND BENEFITS

- | | |
|--|---|
| <ul style="list-style-type: none"> • Super high resolution 700TVL, TRUE Day/Night and Day/Night models • Through Mount Wiring (TMW) • Powerful IR LED illuminators for extreme low or no light applications • Smart IR Technology that automatically adjusts IR LED intensity to changing lighting conditions • Varifocal or fixed lens options | <ul style="list-style-type: none"> • Small unobtrusive sized housings • IP67 environmental housing rating • BNC / DC Jack or 2-pin power wiring connections • Very low power usage • 12VDC power supply included |
|--|---|

ORDERING INFORMATION

SCN#	Item
A-CB7T2812PI	Camera, Bullet, 700TVL, TRUE D/N, 2.8~12mm VF, 12VDC, IR LEDs
A-CB7D36PI	Camera, Bullet, 700TVL, D/N, 3.6mm 12VDC, IR LEDs
A-CB7D60PI	Camera, Bullet, 700TVL, D/N, 6.0mm 12VDC, IR LEDs



Business Solutions

Compact, 700TVL Bullet Cameras

Product Specifications

Video

Image sensor	1/3" Sony Super HAD CCD
Number of pixels	1020 (H) x 508 (V)
Scanning system	NTSC 2:1 interlace
Sync system	Internal
Electronic shutter	1/60~100,000 sec
Resolution	700TVL
Min. illumination	0.1 lux (Color) 0 lux (BW, IR On)
Video output	1.0 Vp-p (75 ohm)
S/N ratio	More than 50dB (AGC off)
Number of LEDs	30
LED Light Range	60ft (18M)
Lens	2.8~12mm Vari-focal AI

Functions

Gamma	0.45
Auto Exposure	n/a
AGC	Auto
Day/Night	Auto (ICR)
White Balance	Auto (ATW)
2D-DNR	ON
Smart IR	ON

Mechanical

Power Input	DC Jack
Video Output	BNC Composite
Lens Mount	Fixed

Environmental

Operating Temperature	-4°F~-122°F (-20°C~+50°C)
Operating Humidity	0~96% (non-condensing)
Protection Rating	IP67

General

Dimensions	ø2.6" x 3.8" x 6.7" (ø66mm x 97mm x 171mm)
Housing	Powder coat aluminum w/sun shield
Cable entry	Through Mount Wiring (TMW)
Weight	1.06 lb. (0.48 kg)

Power

Power Voltage	DC 12V +/- 10%
Power consumption	4.5 Watts (IR LEDs On)

Conformity Approvals

UL, CE, FCC, RoHS

Specifications are subject to change without notice.

Dimensions

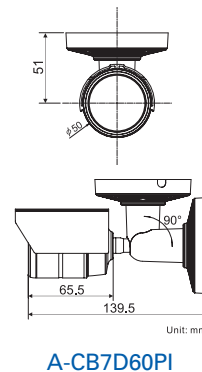
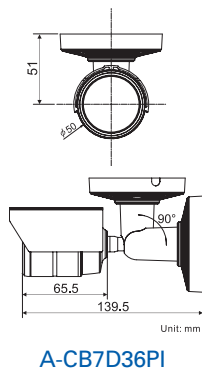
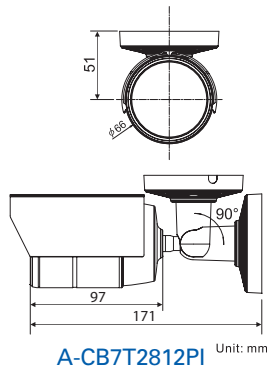

A-CB7D36PI

Image sensor	1/3" Sony Super HAD CCD
Number of pixels	1020 (H) x 508 (V)
Scanning system	NTSC 2:1 interlace
Sync system	Internal
Electronic shutter	1/60~100,000 sec
Resolution	700TVL
Min. illumination	0.1 lux (Color) 0 lux (BW, IR On)
Video output	1.0 Vp-p (75 ohm)
S/N ratio	More than 50dB (AGC off)
Number of LEDs	24
LED Light Range	30ft (9M)
Lens	3.6mm AI

Gamma	0.45
Auto Exposure	ON
AGC	ON
Day/Night	Auto
White Balance	Auto (ATW)
2D-DNR	ON
Smart IR	ON

Power Input	2-pin terminal block
Video Output	BNC Composite
Lens Mount	Fixed

Operating Temperature	-4°F~-122°F (-20°C~+50°C)
Operating Humidity	0~96% (non-condensing)
Protection Rating	IP67

Dimensions	ø1.97" x 2.58" x 5.5" (ø50mm x 65.5mm x 139.5mm)
Housing	Powder coat aluminum w/sun shield
Cable entry	Through Mount Wiring (TMW)
Weight	0.6lb (.28kg)

Power Voltage	DC 12V +/- 10%
Power consumption	4.5 Watts (IR LEDs On)

UL, CE, FCC, RoHS

A-CB7D60PI

Image sensor	1/3" Sony Super HAD CCD
Number of pixels	768 (H) x 494 (V)
Scanning system	NTSC 2:1 interlace
Sync system	Internal
Electronic shutter	1/60~100,000 sec
Resolution	700 TVL
Min. illumination	0.1 lux (Color) 0 lux (BW, IR On)
Video output	1.0 Vp-p (75 ohm)
S/N ratio	More than 50dB (AGC off)
Number of LEDs	24
LED Light Range	30ft (9M)
Lens	6mm AI

Gamma	0.45
Auto Exposure	ON
AGC	ON
Day/Night	Auto
White Balance	Auto (ATW)
2D-DNR	ON
Smart IR	ON

Power Input	2-pin terminal block
Video Output	BNC Composite
Lens Mount	Fixed

Operating Temperature	-4°F~-122°F (-20°C~+50°C)
Operating Humidity	0~96% (non condensing)
Protection Rating	IP67

Dimensions	ø1.97" x 2.58" x 5.5" (ø50mm x 65.5mm x 139.5mm)
Housing	Powder coat aluminum w/sun shield
Cable entry	Through Mount Wiring (TMW)
Weight	0.6lb (.28kg)

Power Voltage	DC 12V +/- 10%
Power consumption	4.5 Watts (IR LEDs On)

UL, CE, FCC, RoHS

For more information visit www.ADT-Matrix.com

© 2013 ADT—All Rights Reserved. ADT Security Services Inc. ADT, the ADT logo and ADT Always There are registered trademarks of ADT Services AG and are used under license.

