

## Instruction Manual

### ***WALL/CEILING MOUNT BRACKET***

---

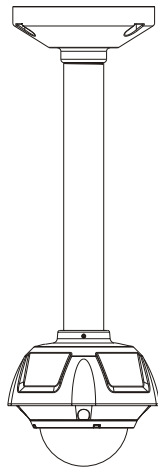

**Ceiling Type**

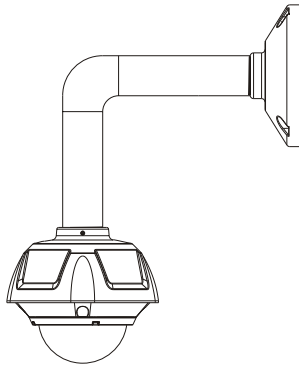

**Wall Type**



VF



VF1

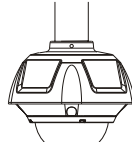

VS1

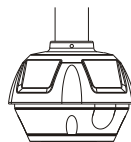

VS2

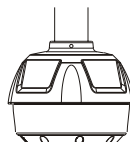

VS4

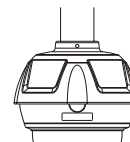

VP

*Please read this manual thoroughly before use, and keep it handy for future reference.*

### 3. SPECIFICATIONS

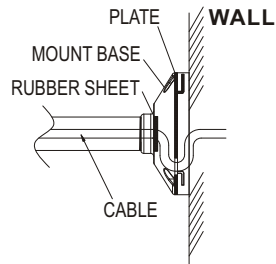

1. Cable passing through the wall

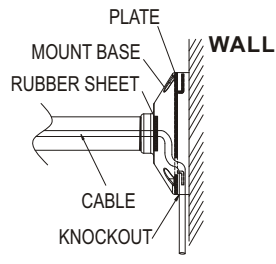

2. Cable on the wall (Remove the conduit knockout for cable passing through)

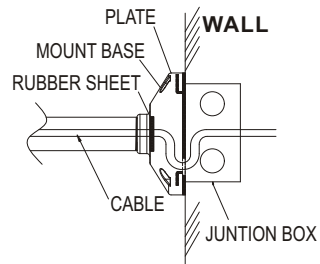

3. Cable Passing through the wall with the junction box  
(Attention to the plate side)

### 4. DIMENSION DRAWING

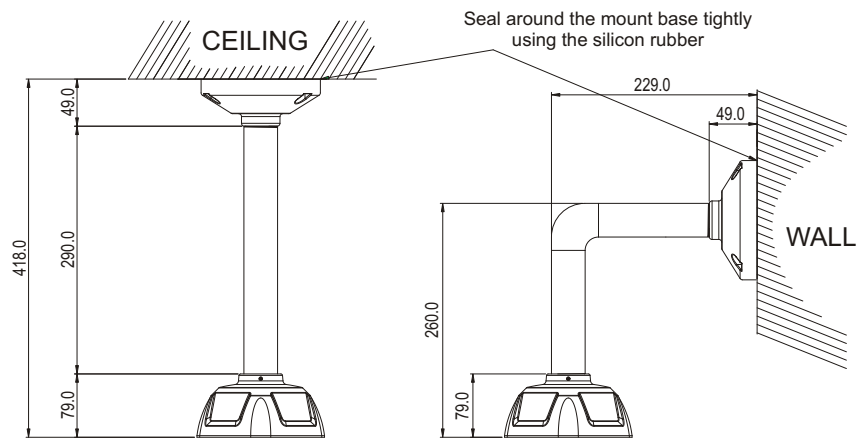

(Unit: mm)

[ Mount Base Size ]

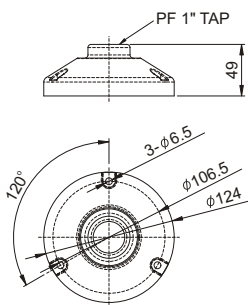

<b>Pipe Specification</b>	1" PT TAP
<b>Construction</b>	Aluminum and steel
<b>Maximum Load</b>	Approx 11 lbs (5 kg)
<b>Weight - Unit Shipping</b>	Approx 2.6 lbs (1.2 kg) Approx 3.5 lbs (1.6 kg)

## EXPLODE VIEW

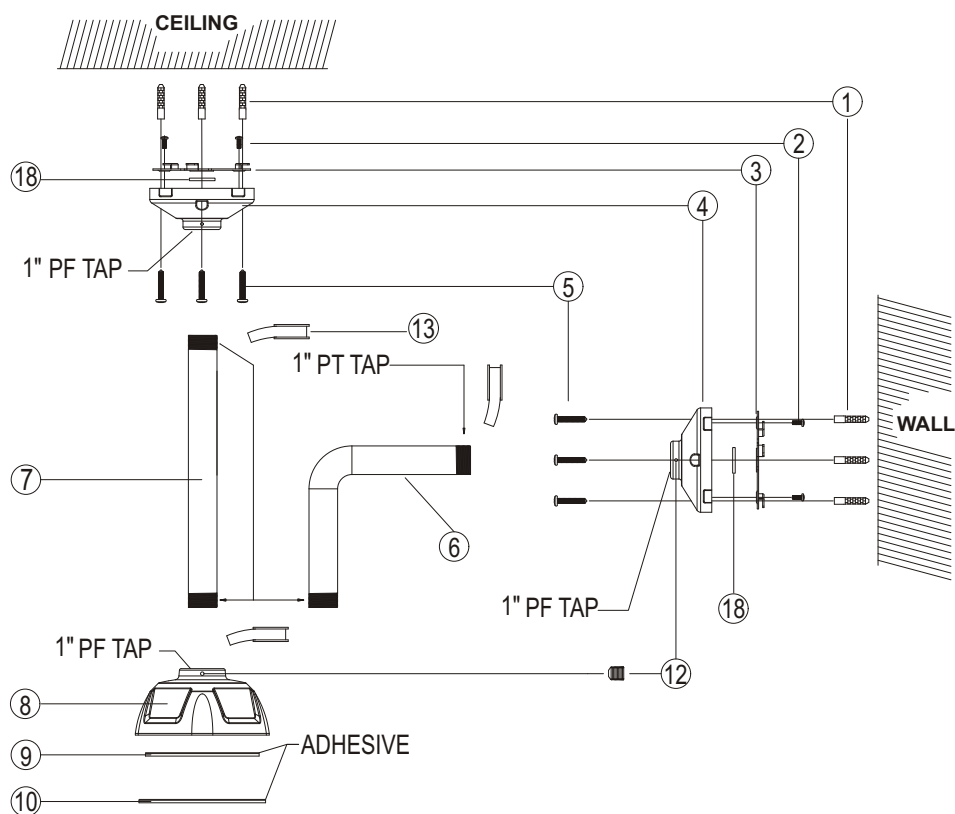

## How to install the plate

### • Ex1. Without junction box

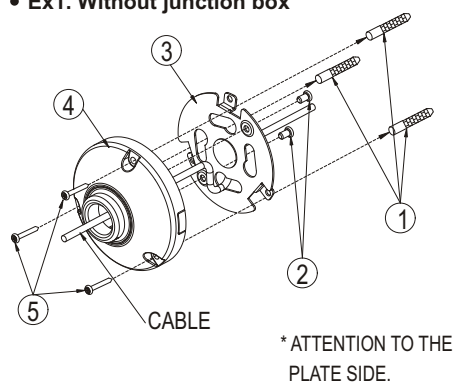

### • Ex2. With junction box

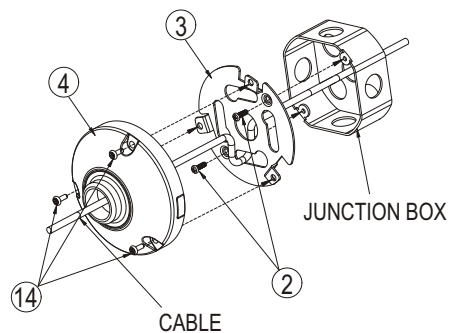

## 1. ASSEMBLY PARTS LIST

ITEM	Q' TY	PART NAME	DESCRIPTION
1	3	PLASTIC BUSHING	ANCHOR (ø 6.0mm)
2	2	MACHINE SCREW	UNC #8-32 SCREW (L=8mm)
3	1	PLATE	GI 1.6t
4	1	MOUNT BASE	PF 1", ALUMINUM
5	3	SCREW TAPPING	M6, L = 35.0mm
6	1	PIPE (90° ANGLE TYPE)(Option)	PF 1", ALUMINUM
7	1	PIPE (STRAIGHT)(Option)	PF 1", ALUMINUM
8	1	HOUSING	PF 1", ALUMINUM
9	1	GASKET 1	for VF
10	1	GASKET 2	for VF1, VS1, VS2, VP
11	4	TORX SCREW	T-20 (M6 x 20.0)
12	2	SET SCREW	M5 x 5.0mm
13	1	SEAL TAPE	TEFLON
14	3	MACHINE SCREW	M6 x 12.0
15	1	SPECIAL SCREW	for VF, VP
16	1	TORX WLENCH	T-20
17	1	L-WRENCH	
18	2	RUBBER SHEET	(Only single cable should be used.)

## 2. INSTALLATION

1. Attach the mounting base (④) and plate (③) to the ceiling or wall using the supplied M6 tapping screws (⑤) and plastic bushings(①)  
(Please refer to page 3 for fabrication method of plate)
2. Wind Teflon tape (⑬) around both threaded ends of the pipe (about 20times) for sealing.  
If necessary, use a silicone rubber sealant to seal the area where the mount base and the pipe meet.
3. Fit the pipe (of which threads are covered by teflon tape) into the mount base (④) and turn until it is securely fastened.
4. Pull all the required cables through the mount base(④) and pipe(⑥, ⑦).
5. Align the housing (⑧) with the pipe and turn until it is securely fastened.
6. Fasten the mount base (④), housing (⑧) using the set screw (⑫).
7. Install the vandal proof dome housing to the housing (⑧) using M6 torx screws (T-20) (⑪).

\*Fit the screw holes of vandal dome housing into the screw holes of housing(6) and screw up the M6 torx screws



\*Screw up the special screw(15) before install the vandal proof dome housing.

