

PENDENT MOUNT DOME BRACKET INSTALLATION

Use the Tapping screw to align the pendent mount bracket holes to dome housing holes.

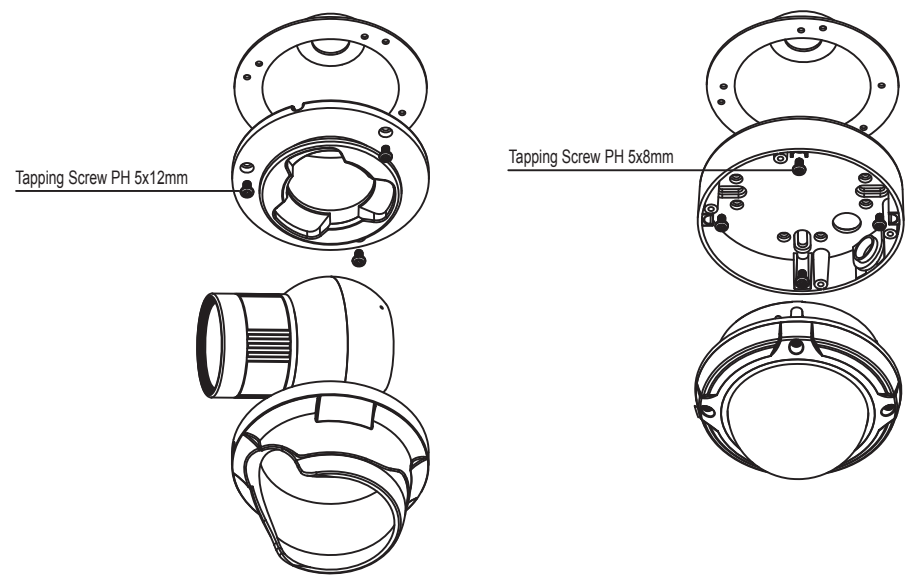

PARTS LIST

NO	PART NAME	Q'TY	DESCRIPTION
1	PENDENT MOUNT BRACKET	1	STEEL SHEET
2	TAPPING SCREW	3	5 x 12mm
3	TAPPING SCREW	4	5 x 8mm

* NOT INVOLVED IN PRODUCT.

PRODUCT FEATURES

- Light duty Wall Mount
- Press & Steel Sheet
- Easy and safe to install

This mount is light duty wall mount
Designed for use with enclosure.

This mount is capable of supporting
Loads up to 2.2lb [1.0 kg]



SPECIFICATION

GENERAL

Enclosure mounting	Machine screw [supplied]	Inlet dimension	26.5Ø(3/4"EMT)
Construction	Press & Steel Sheet	Dimension	See dimensional outline
Finish	Polyester powder coat	Weight	Unit 0.55 lb [0.25 kg]
Maximum load	2.2lb [1.0 kg]		

DIMENSION

